

TECHNICAL DATA SHEET "M6 PLUG"

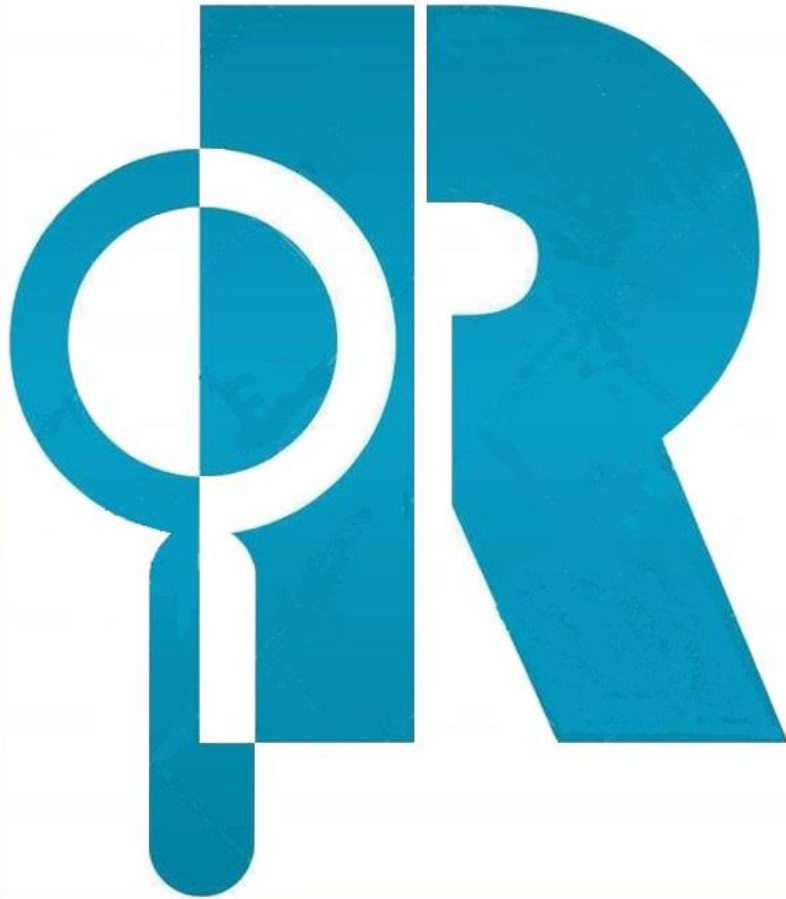

INNOVATION R. LTD

DIMENSIONS

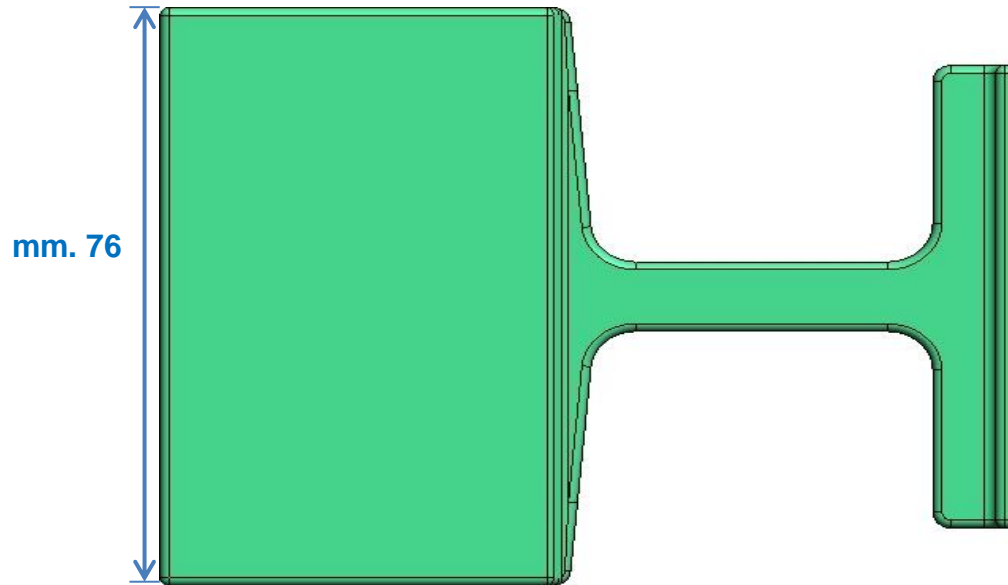
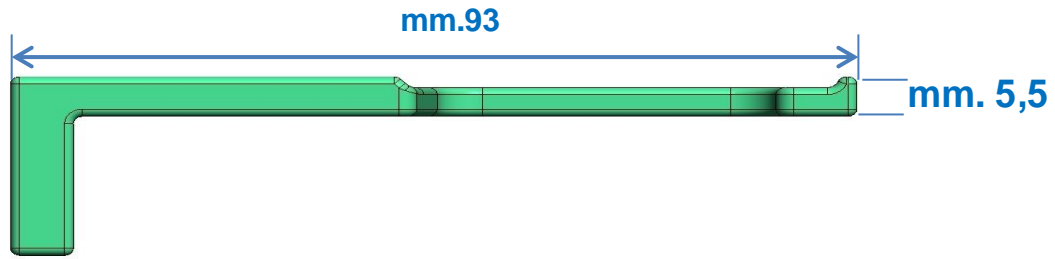

SYSTEM DESCRIPTION PLUG M6

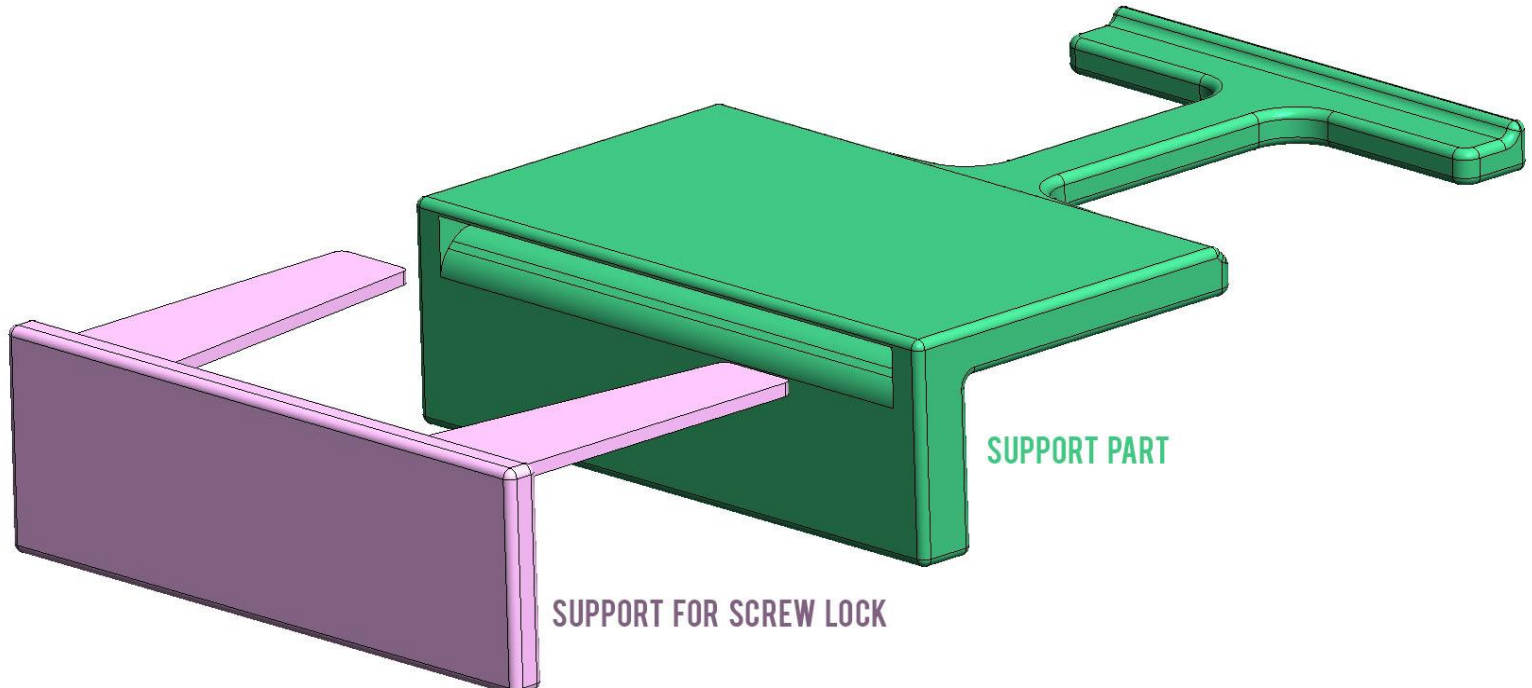

The sliding part “support for screw lock” acts as a support for the piece to be fixed.

The function of the M6 system is to create fixing points in the walls without altering the technical characteristics of the masonry and its components

CHARACTERISTICS

- The main feature of the plug M6 is the absence of any type of screws
- The screw used for fastening also works as an adjusting screw
- The inserted screw for fixing does not deform the plug M6



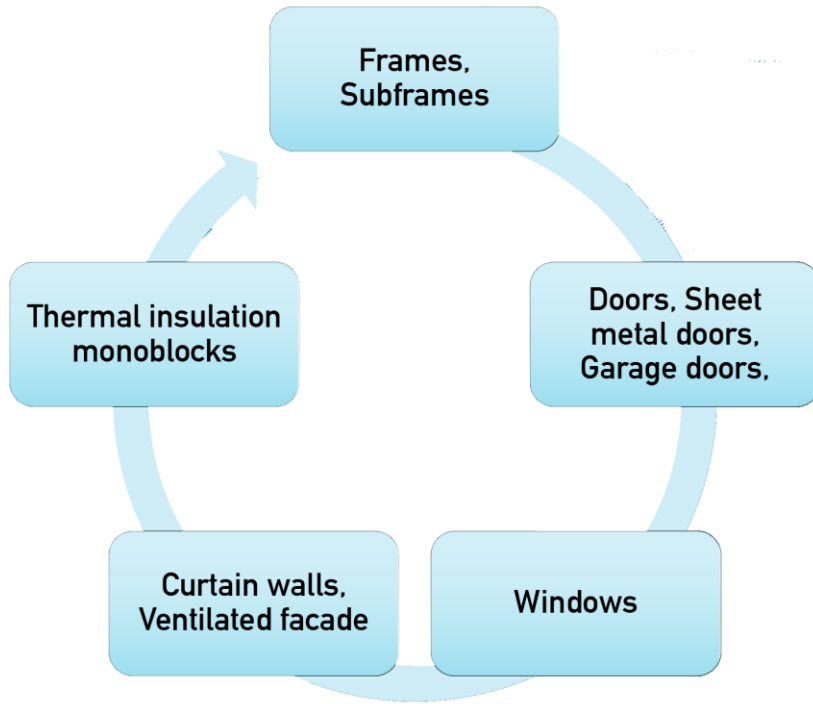

ADVANTAGES

- The plug M6 does not create thermal bridges
- The plug can be applied in internal walls and external walls
- The application of the plug keeps the technical properties of the masonry unaltered

APPLICATION

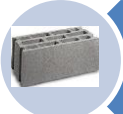
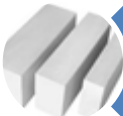
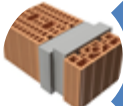

SUPPORT MATERIALS

-  > Bricks
-  > Load-bearing brick
-  > Thermo-acoustic brick
-  > Thermal insulation brick
-  > Concrete block
-  > Cellular concrete block
-  > Anti-seismic load-bearing brick

LOAD TEST, TRACTION

PERFORMED WITH THE M6 SYSTEM	Fu Recom. Range	Fm Maximum capacity
with self- drilling screw for metal, nominal diameter mm. 5	Kg. 136	Kg. 249

The reported data refer to laboratory tests.

In building applications these can be modified according to the conditions of installation.

However, the installer must check the suitability of the product for the intended use, assuming all responsibility for incorrect use and application.